

PERENCANAAN TEKNOLOGI  
& SISTEM BANGUNAN  
(PTSB) 03

Home | Blog | Research | Publication | Lecturing



About me:



Lecturer on Building Sciences

Department of Architecture

Latest Blog:

PTS3 1011\_RALAT Kelompok Bimbingan  
2011-03-29 11:00:14

MK. PERPAK 2  
2011-03-28 09:58:41

KBK & SAP PTSB 3  
2011-03-22 09:47:13

MK. METODA DESAIN\_Handouts & Readers  
2011-03-17 21:12:36

PTS3 1011\_Handout  
2011-03-15 22:08:54

>> Index

<http://www.unika.ac.id/staff/Moediartianto>

STRIVING FOR  
excellence

Jl. Pawiyatan Luhur IV/1 Bendhan Dhuwur Semarang 50234  
Telp. 024 - 8441555 (hunting) Fax. 024 - 8415429, 8445265  
Website: <http://www.unika.ac.id>

Created by: Robertus Nugroho

## PERTEMUAN 1: PENGANTAR

# TUJUAN

Mengenal elemen-elemen dalam konstruksi bangunan, mengenal permasalahan yang sering terjadi pada konstruksi bangunan rumah tinggal, mengenal logika gaya dan statika dalam konstruksi, aspek-aspek utilitas dan kinerja bangunan rumah tinggal (+jasa / perdagangan) bertingkat rendah.

Untuk mencapai tujuan tersebut sistem pembelajaran diwujudkan dalam bentuk tutorial, *workshop* di dalam kelas, ekskursi serta tugas mandiri di luar kelas.

OUTLINE

INTRODUCTION

**Course Objective**

Competency

Assignment

DRA family house,  
a steel construction suspended by *querkraft* architect



OUTLINE

INTRODUCTION

Course Objective

Competency

Assignment

## PERTEMUAN 1: PENGANTAR

*Ars sine scientia nihil est!*  
*Skill without knowledge is of no value*

Dictum of Mignot [1400]

OUTLINE

**INTRODUCTION**

Course Objective

Competency

Assignment



# PERTEMUAN 1: PENGANTAR

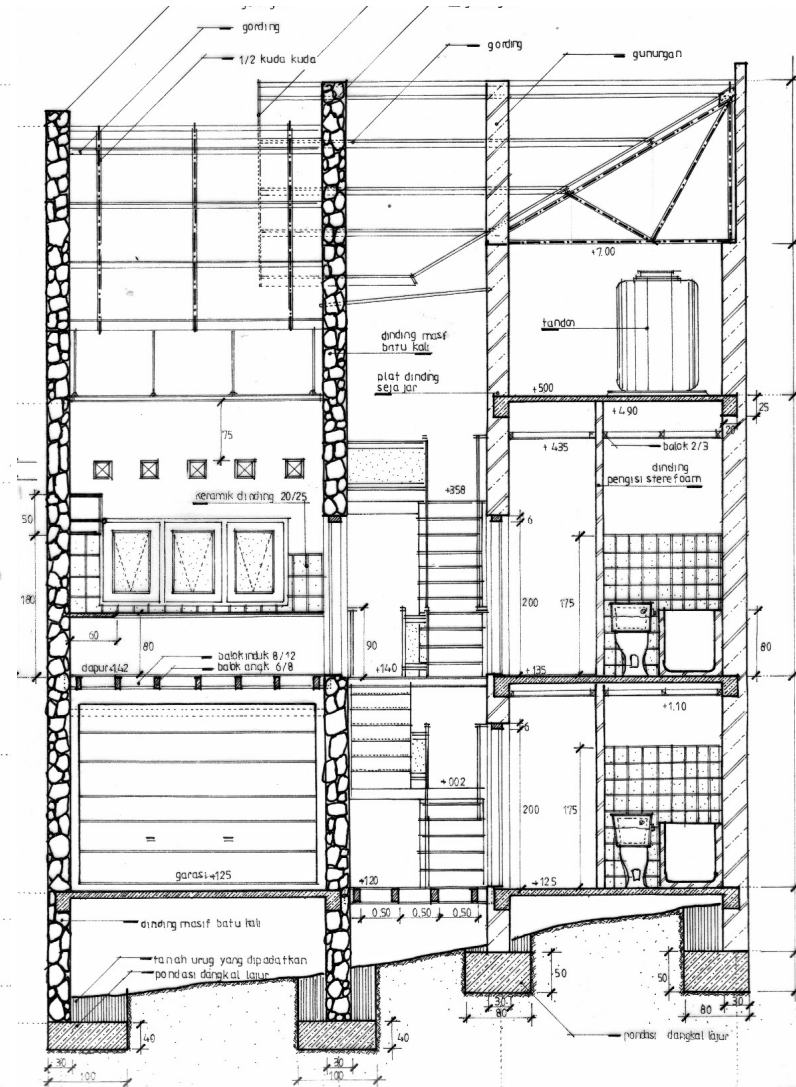
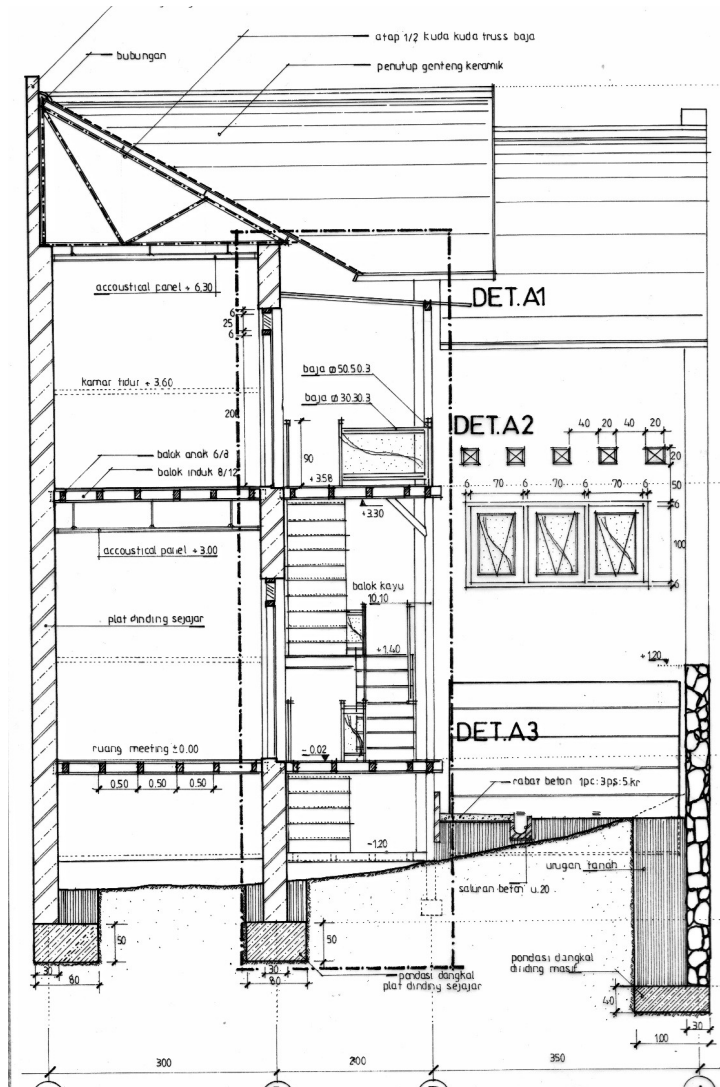

OUTLINE

INTRODUCTION

Course Objective

Competency

Assignment

# PERTEMUAN 1: PENGANTAR

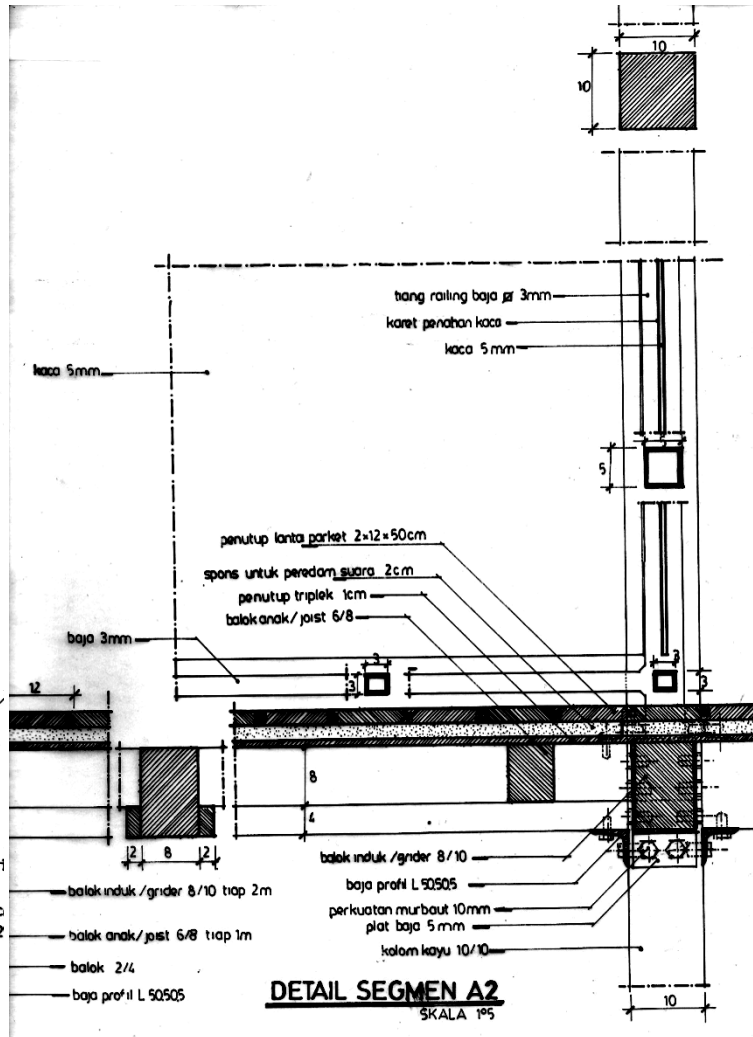
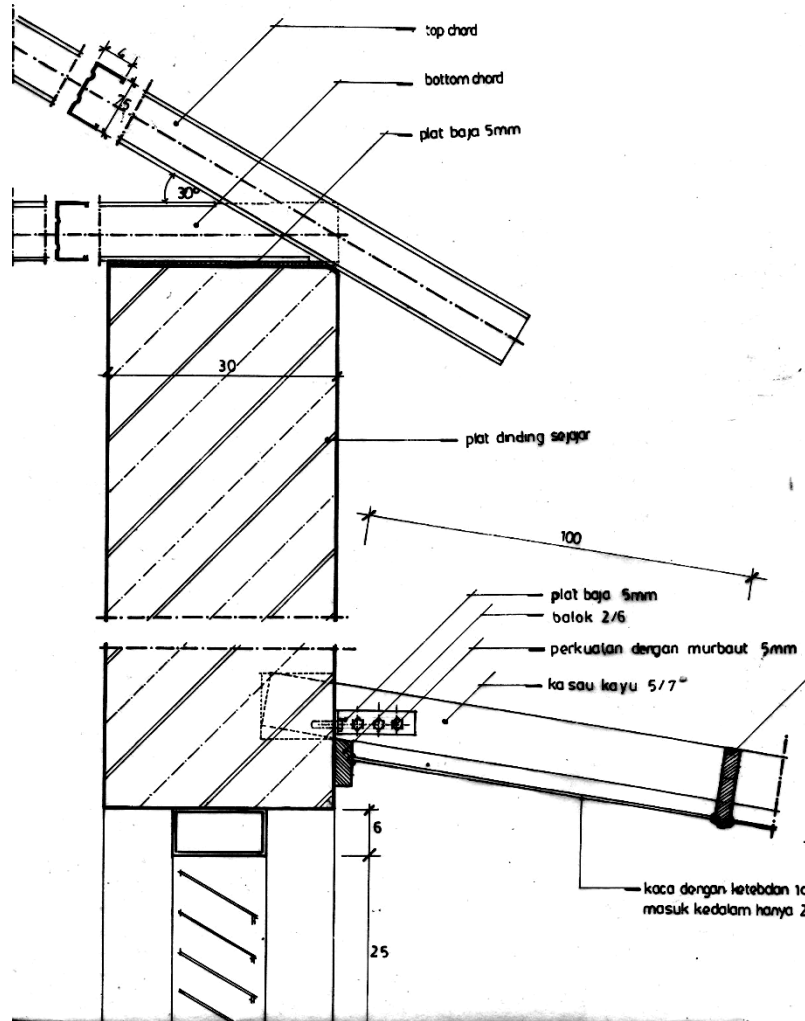

OUTLINE  
 INTRODUCTION  
 Course Objective  
 Competency  
 Assignment

# PERTEMUAN 1: PENGANTAR

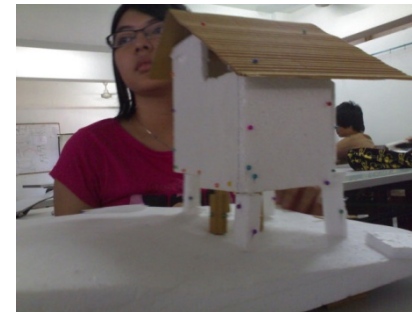
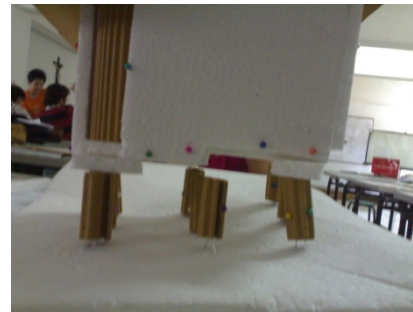
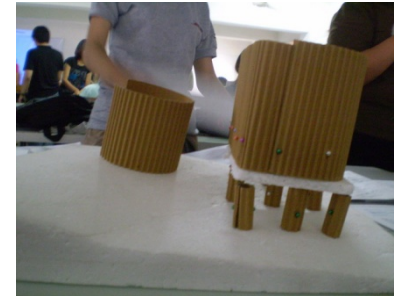
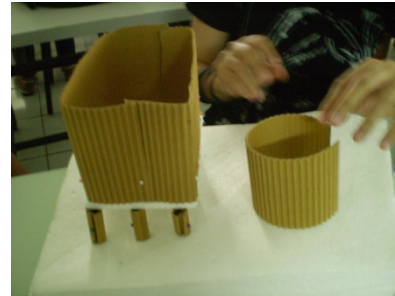
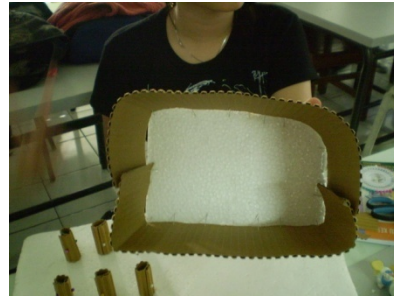



## PERTEMUAN 1: PENGANTAR

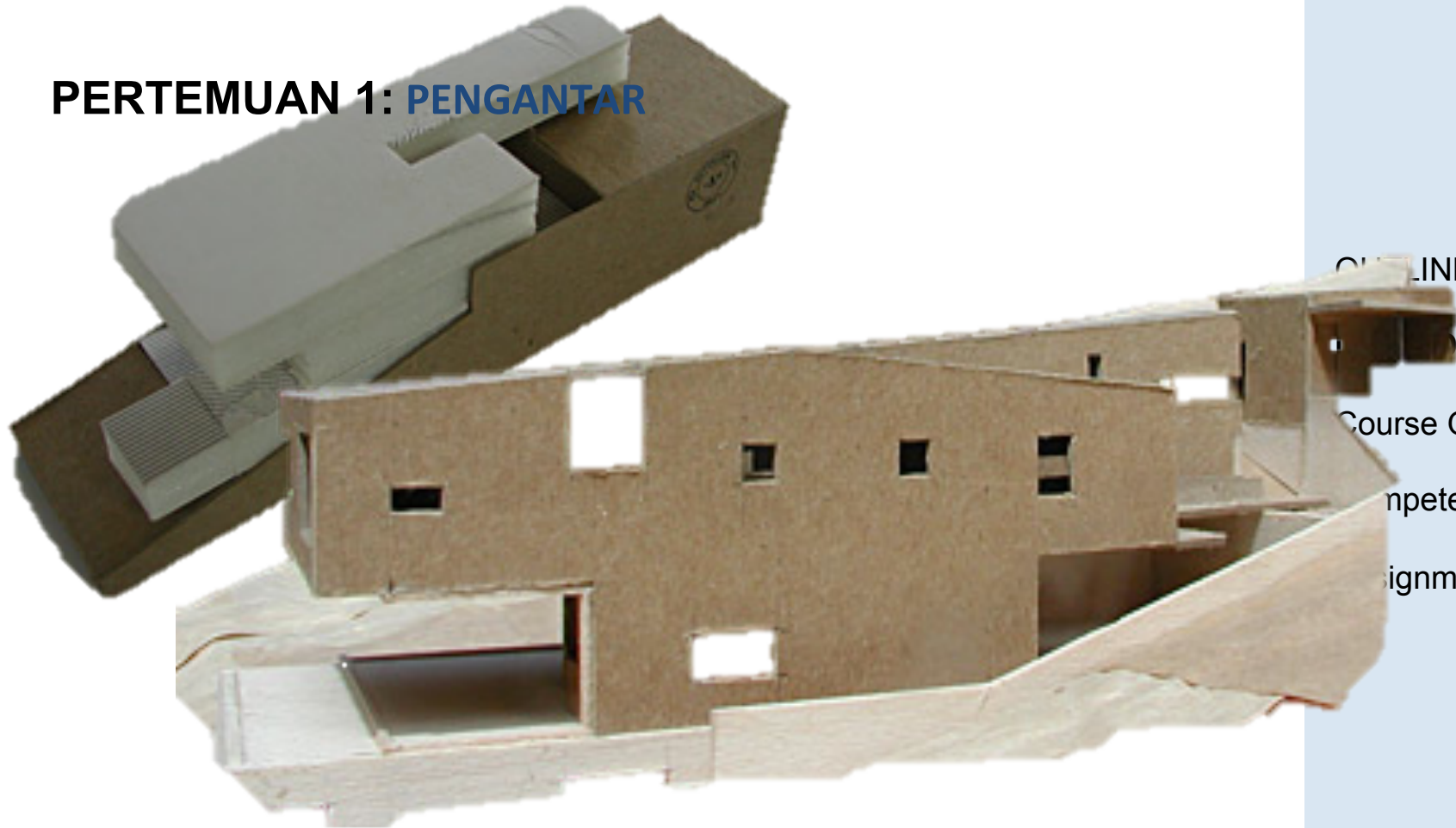

Models are **good mediums** to give feeling of the topography and study the building construction.

OUTLINE

1. INTRODUCTION

Course Objective

Competency

Assignment

## PERTEMUAN 1: PENGANTAR

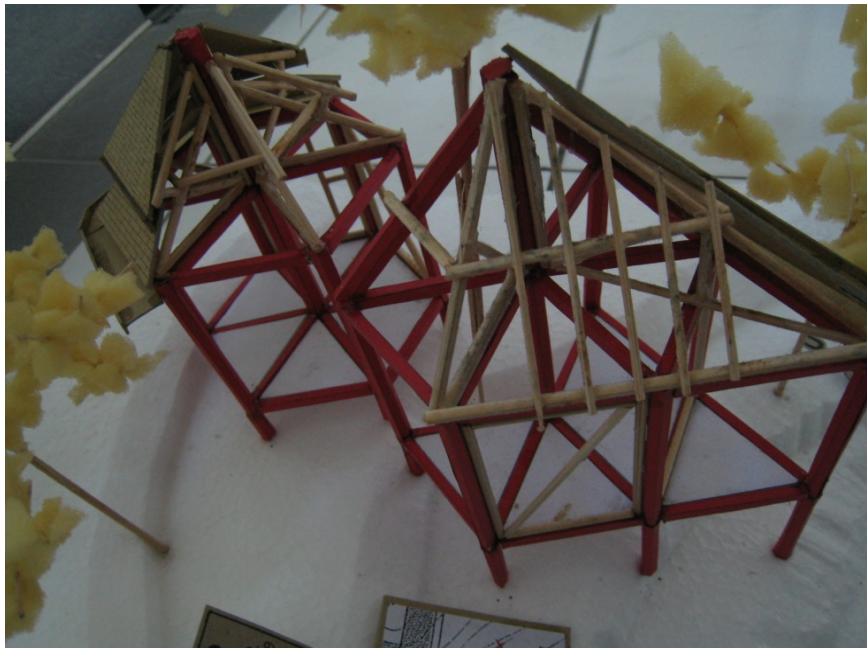

Models are **good mediums** to give feeling of the topography and study the building construction.

OUTLINE

**INTRODUCTION**

Course Objective

Competency

Assignment



Models are **good mediums** to give feeling of the topography and study the building construction.

OUTLINE

**INTRODUCTION**

Course Objective

Competency

Assignment



# PERTEMUAN 1: PENGANTAR



OUTLINE

**INTRODUCTION**

Course Objective

Competency

Assignment